



BARLEY CLOSE | | ST ALBANS | AL4 0LY

ASKING PRICE £800,000

LIVINGSPLACE  
ESTATE AGENTS

BARLEY CLOSE |  
ST ALBANS | AL4 0LY  
ASKING PRICE £800,000

WELCOME TO THIS CHARMING 3-BEDROOM, 3-BATHROOM FAMILY HOME LOCATED ON THE DESIRABLE BARLEY CLOSE IN THE HEART OF ST ALBANS. THIS BEAUTIFULLY PRESENTED PROPERTY OFFERS SPACIOUS AND VERSATILE LIVING ACCOMMODATION, PERFECT FOR MODERN FAMILY LIFE.

UPON ENTERING, YOU ARE GREETED BY A BRIGHT AND AIRY HALLWAY LEADING TO A GENEROUS LIVING ROOM, IDEAL FOR RELAXING AND ENTERTAINING. THE CONTEMPORARY KITCHEN IS FITTED WITH HIGH-QUALITY APPLIANCES AND PROVIDES AMPLE SPACE FOR DINING. THE THREE WELL-PROPORTIONED BEDROOMS INCLUDE A MASTER SUITE WITH A PRIVATE EN-SUITE BATHROOM, ALONG WITH TWO ADDITIONAL BEDROOMS SERVED BY A STYLISH FAMILY BATHROOM.

- DETACHED
- SHOWER
- ALLOCATED PARKING
- 3 BATHROOMS
- NO SPECIAL ACCESSIBILITY
- GARDEN

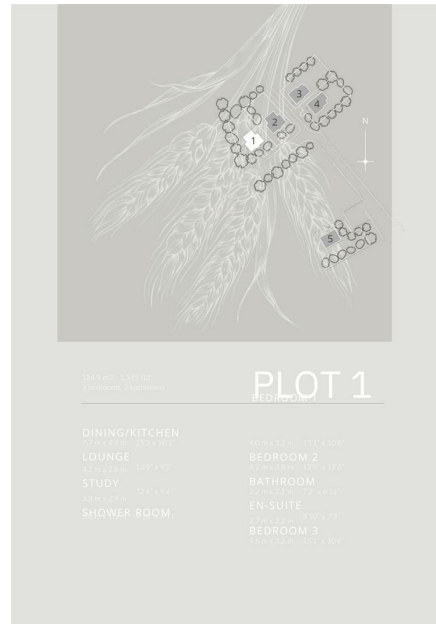

Energy Efficiency Rating		Current	Potential
<i>Very energy efficient - lower running costs</i>			
(92 plus) <b>A</b>			
(81-91) <b>B</b>			
(69-80) <b>C</b>			
(55-68) <b>D</b>			
(39-54) <b>E</b>			
(21-38) <b>F</b>			
(1-20) <b>G</b>			
<i>Not energy efficient - higher running costs</i>			
<b>England &amp; Wales</b>	EU Directive 2002/91/EC		

COUNCIL TAX BAND F  
EPC RATING

105 ST PAULS ROAD  
ISLINGTON  
LONDON  
N1 2NA  
020 7354 0505  
INFO@LSEA.CO.UK